

# ST VINCENT'S PRIVATE HOSPITAL TOOWOOMBA

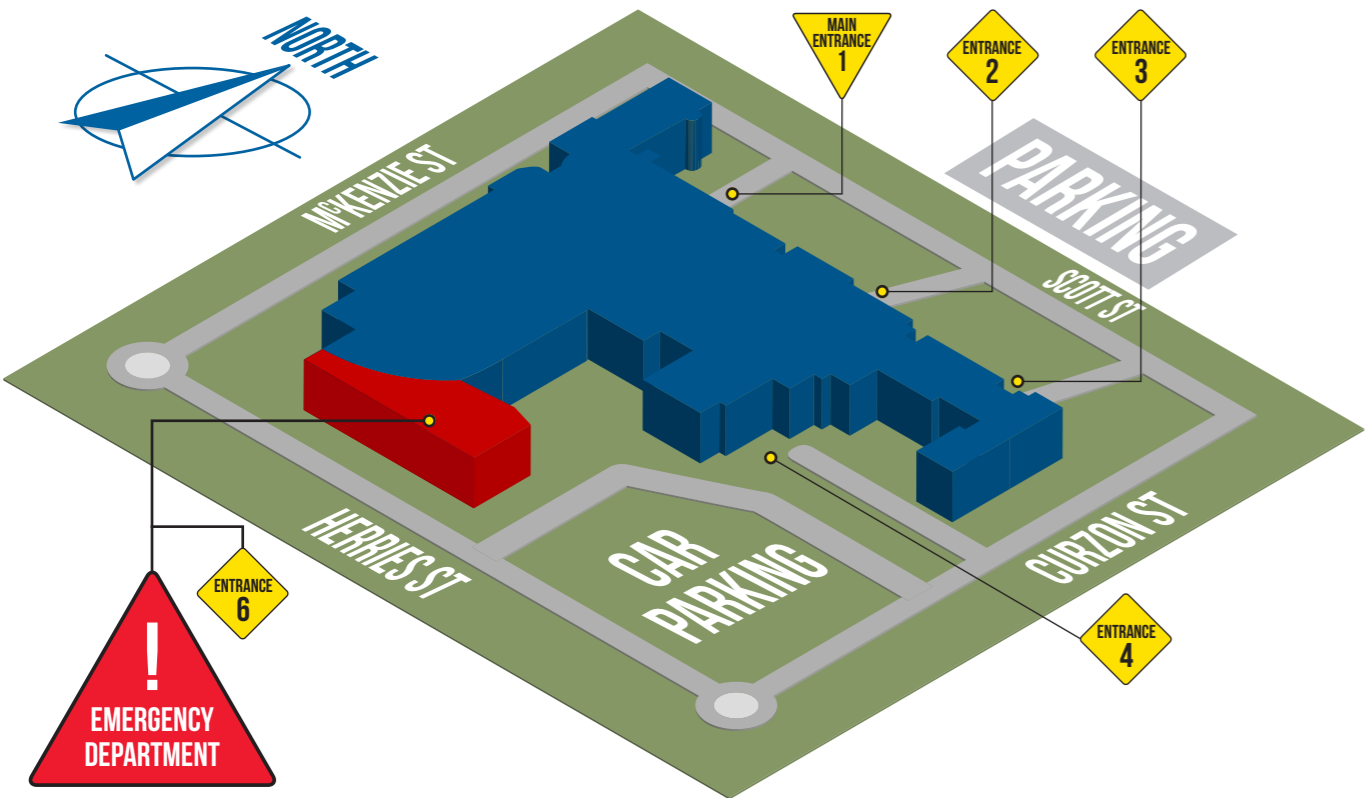

<b>Entrance 1</b>	Patient Admission
	Patient Discharge
<b>Entrance 2</b>	Doctor Suites
<b>Entrance 3</b>	Doctor Suites /Medical Centre
<b>Entrance 4</b>	Doctor Suites
<b>Entrance 6</b>	24-Hour Access
	Emergency Department
	Qld X-ray
	Visitor Entrance
	Intensive Care Unit

## INPATIENT WARDS & DEPARTMENTS



- LEVEL 2**
  - St Anne's Unit (Orthopaedics)
  - St Michael's Unit (Rehabilitation)
  - Allied Health
- LEVEL 1**
  - St Luke's Unit (Cardiac)
  - St Raphael's Unit (Medical)
- GROUND**
  - Dorothea Devine (Maternity)
  - St Damian's Unit (Surgical)
  - St Gabriel's Unit (Children)

- LOWER GROUND**
  - MAIN RECEPTION
    - Front Admissions, Discharge
    - Chapel
    - Operating Theatres
    - Lifts to wards
    - Pathology
    - Pharmacy
    - Hospital Executive

## DEPARTMENTS VIA ENTRANCE 2



- LEVEL 2**
  - Doctor Suites
  - Clinical School
- LEVEL 1**
  - Day Unit (Wounds, Infection)
  - Doctor Suites
- GROUND**
  - Doctor Suites

## DEPARTMENTS VIA ENTRANCE 3



- HOSPITAL ENTRANCE**
  - MEDICAL CENTRE
  - Doctor Suites

## DEPARTMENTS VIA ENTRANCE 4



- HOSPITAL ENTRANCE**
  - Pre Admissions
  - Allied Health
  - Endoscopy

## DEPARTMENTS VIA ENTRANCE 6



- HOSPITAL ENTRANCE**
  - VISITOR ENTRANCE
  - Emergency Department
  - Queensland X-Ray
  - Café
  - Florist
  - Intensive Care Unit